



DeWALT®

instruction maintenance and parts

IMPORTANT:

DO NOT CUT FERROUS METALS.
DO NOT USE ABRASIVE WHEELS.
DO NOT USE STRONG SOLVENTS.
PERMANENT DAMAGE MAY RESULT.

**KEEP THIS BOOKLET
WITH THE SAW**

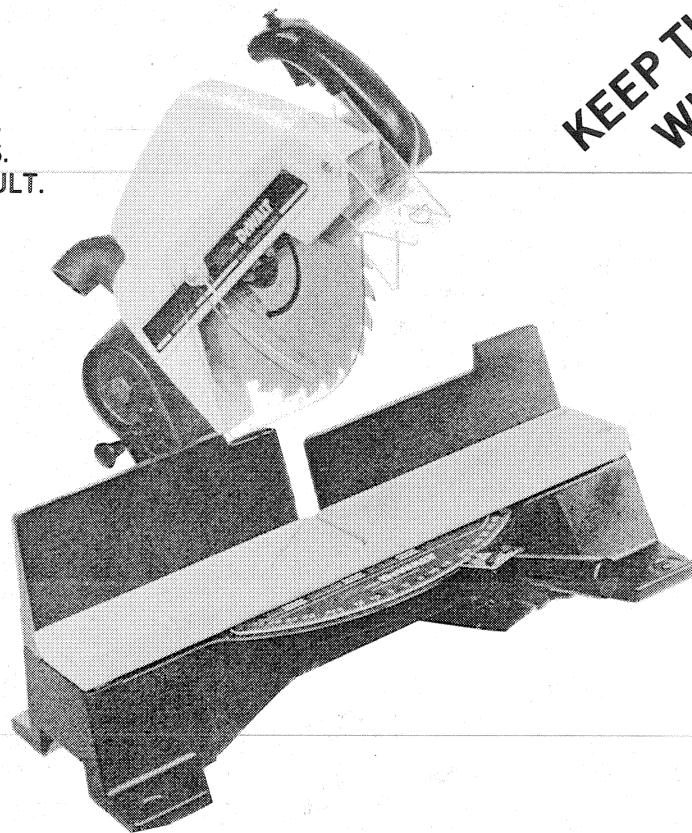

WARNING: FOR YOUR OWN SAFETY READ THIS MANUAL BEFORE OPERATING TOOL.

This booklet is provided for your convenience in the use and care of your new DeWalt Saw. These instructions include operation, usage, precautions, preventive maintenance, maintenance and other pertinent data to assist you in assuring long life and dependable service from your saw.

10" POWER MITER BOX

CATALOG NO. 7717

TYPE 2

BULLETIN NO. 9127-1

MODEL NO.	TYPE	VOLTS	CYCLE	PH.
7717	2	120	25-60	1

INDEX

Unpacking & Assembly	2
Rules for Safer Operation	2
Electrical Connection	2
Control Locations & Functions	3
Operating Instructions	4, 5
Adjustment & Alignment	5, 6
Preventive Maintenance	6
Accessories	6
Service Parts Lists	7
Warranty & Service Centers	Back Cover

UNPACKING & ASSEMBLY

Your DeWalt Power Miter Box is completely assembled, aligned and inspected at the factory, then partially disassembled for shipment. To unpack, remove the unit and hardware bag from the carton. Place the unit in the desired location on a work bench, accessory machine stand or strong table. If the unit is to be used in one location, fasten it to the bench or table using screws or bolts through the holes in the four mounting feet. Be sure to shim to remove any irregularities between the mounting feet and the mounting surface to prevent distorting the base casting.

Unpack the hardware bag, remove the handle (33)* and thread it into the front end of the pivot arm (16)* above the miter latch. Refer to the control location and function chart for part names and locations. Place the remaining contents in a safe location.

* See page 7

CAUTION: DO NOT ATTEMPT TO OPERATE THE POWER MITER BOX UNTIL YOU HAVE READ AND UNDERSTAND THE FOLLOWING OPERATING INSTRUCTIONS.

RULES FOR SAFER OPERATION

1. **KEEP GUARDS IN PLACE** and in working order.
2. **REMOVE ADJUSTING KEYS AND WRENCHES.** Form habit of checking to see that keys and adjusting wrenches are removed from tool before turning it on.
3. **KEEP WORK AREA CLEAN.** Cluttered areas and benches invite accidents.
4. **DON'T USE IN DANGEROUS ENVIRONMENT.** Don't use power tools in damp or wet locations, or expose them to rain. Keep work area well lighted.
5. **KEEP CHILDREN AWAY.** All visitors should be kept a safe distance from work area.
6. **MAKE WORKSHOP KID PROOF** with padlocks, master switches, or by removing starter keys.
7. **DON'T FORCE TOOL.** It will do the job better and be safer at the rate for which it was designed.
8. **USE RIGHT TOOL.** Don't force tool or attachment to do a job for which it was not designed.
9. **WEAR PROPER APPAREL.** No loose clothing, gloves, neckties, rings, bracelets, or other jewelry to get caught in moving parts. Non-slip footwear is recommended. Wear protective hair covering to contain long hair.
10. **ALWAYS USE SAFETY GLASSES.** Also use face or dust mask if cutting operation is dusty. Everyday eyeglasses only have impact resistant lenses, they are NOT safety glasses.
11. **SECURE WORK.** Use clamps or vise to hold work when practical. It's safer than using your hand and it frees both hands to operate tool.
12. **DON'T OVERREACH.** Keep proper footing and balance at all times.

13. **MAINTAIN TOOLS WITH CARE.** Keep tools sharp and clean for best and safest performance. Follow instructions for lubricating and changing accessories.
14. **DISCONNECT TOOLS** before servicing; when changing accessories such as blades, bits, cutters, etc.
15. **REDUCE THE RISK OF UNINTENTIONAL STARTING.** Make sure switch is in off position before plugging in.
16. **USE RECOMMENDED ACCESSORIES.** Consult the owner's manual for recommended accessories. The use of improper accessories may cause risk of injury to persons.
17. **NEVER STAND ON TOOL.** Serious injury could occur if the tool is tipped or if the cutting tool is unintentionally contacted.
18. **CHECK DAMAGED PARTS.** Before further use of the tool, a guard or other part that is damaged should be carefully checked to determine that it will operate properly and perform its intended function—check for alignment of moving parts, binding of moving parts, breakage of parts, mounting, and any other conditions that may affect its operation. A guard or other part that is damaged should be properly repaired or replaced.
19. **DIRECTION OF FEED.** Feed work into a blade or cutter against the direction of rotation of the blade or cutter only.
20. **NEVER LEAVE TOOL RUNNING UNATTENDED. TURN POWER OFF.** Don't leave tool until it comes to a complete stop.

ADDITIONAL RULES FOR THE POWER MITER BOX

1. DO—Protect line with at least a 15 ampere time delay fuse.
2. DO—Make certain the blade rotates in the correct direction.
3. DO—Be sure all clamp handles are tight before starting any operation.
4. DO—Be sure blade and arbor collars are clean and recessed side of collars are against blade. Tighten arbor nut securely, using both wrenches provided.
5. DO—Keep saw blade sharp and properly set.
6. DO—Keep motor air slots clean and free of chips.
7. DO—Use both upper and lower blade guards at all times.
1. DON'T—Attempt to operate on anything but designated voltage.
2. DON'T—Operate unless all clamp handles are tight.
3. DON'T—Use blades of larger diameter than recommended.
4. DON'T—Wedge anything against fan to hold motor shaft.
5. DON'T—Subject table top to variable humidity conditions (keep away from dampness).
6. DON'T—Force cutting action. Stalling or partial stalling of motor can cause major damage. Allow motor to reach full speed before cutting.
7. DON'T—Remove ground prong from plug. Never operate saw unless it is properly grounded.
8. DON'T—Place either hand in the blade area when the saw is connected to the electrical power source.
9. DON'T—Use blades recommended for operation at less than 6000 rpm.
10. DON'T—Attempt to recut small pieces.
11. DON'T—Tape or wedge trigger switch locking button down; permanent loss of switch locking function will result.
12. DON'T—Cut ferrous metals.
13. DON'T—Use abrasive wheels.
14. DON'T—Allow anyone to stand behind the saw.
15. DON'T—Apply lubricants to the blade when it is running.

ELECTRICAL CONNECTIONS AND GROUNDING

This tool should be grounded while in use to protect the operator from electric shock.

We recommend that you **NEVER** disassemble the tool or try to do any rewiring in the electrical system. Any such repairs should be performed only by B&D Service Centers or other qualified service organizations. Should you be determined to make a repair yourself, remember that the green colored wire is the "grounding" wire. Never connect this green wire to a "live" terminal.

1. **Cord-Connected Tools:** In the event of a malfunction or breakdown, grounding provides a path of least resistance for electric current to reduce the risk of electric shock. This tool is equipped with an electric cord having an equipment-grounding conductor and a grounding plug. The plug must be plugged into a matching outlet that is properly installed and grounded in accordance with all local codes and ordinances. Do not modify the plug provided — if it will not fit the outlet, have the proper outlet installed by a qualified electrician. Improper connection of the equipment-grounding conductor can result in a risk of electric shock. The conductor with insulation having an outer surface that is green with or without yellow stripes is the equipment-grounding conductor. If repair or replacement of the electric cord or plug is necessary, do not connect the equipment-grounding conductor to a live terminal. Check with a qualified electrician or serviceman if the grounding instructions are not completely understood, or if in doubt as to whether the tool is properly grounded. Use only 3-wire extension cords that have 3-prong grounding plugs and 3-pole receptacles that accept the tool's plug. Repair or replace damaged or worn cord immediately.

1A. Grounded, cord-connected tools intended for use on a supply circuit having a nominal rating less than 150 volts. This tool is intended for use on a circuit that has an outlet that looks like the one illustrated in Sketch A. The tool has a grounding plug that looks like the plug illustrated in Sketch A. A temporary adapter, which looks like the adapter illustrated in Sketches B and C, may be used to connect this plug to a 2-pole receptacle as shown in Sketch B if a properly grounded outlet is not available. The temp-

orary adapter should be used only until a properly grounded outlet can be installed by a qualified electrician. The green-colored rigid ear, lug, etc. extending from the adapter must be connected to a permanent ground such as a properly grounded outlet box. Adapter shown in Sketches B and C is Not for Use in Canada.

1B. Grounded, cord-connected tools intended for use on a supply circuit having a nominal rating between 150-250 volts, inclusive: This tool is intended for use on a circuit that has an outlet that looks like the one illustrated in Sketch D. The tool has a grounding plug that looks like the plug illustrated in Sketch D. Make sure the tool is connected to an outlet having the same configuration as the plug. No adapter is available or should be used with this tool. If the tool must be reconnected for use on a different type of electric circuit, the reconnection should be made by qualified service personnel; and after reconnection, the tool should comply with all local codes and ordinances.

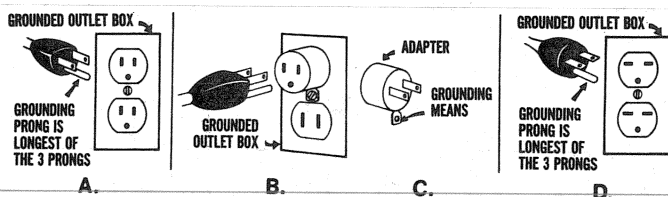

The use of a separate 15 ampere circuit is recommended. Do not connect this tool to a DC power. It will cause damage to the tool.

CONTROL LOCATIONS & FUNCTIONS

- A. **SWITCH BUTTON**—Press to unlock trigger switch, remove to prevent unauthorized operation.
- B. **OPERATING HANDLE**—Used while cutting.
- C. **TRIGGER SWITCH**—Squeeze and hold to cut, releasing the switch activates the automatic brake.
- D. **MITER LATCH**—Accurately locates 0°, 22½° left and right and 45° left and right, pull upward to select miter angle.
- E. **MITER CLAMP KNOB**—Tighten lightly to maintain desired miter angle.
- F. **PIVOT ARM**—Rotate to select desired miter angle.
- G. **MITER SCALE & POINTER**—Indicates miter angle.
- H. **DUST SPOUT**—Orient to direct sawdust ejection.
- I. **CARRYING LOCK**—Lower blade and push in to lock blade down, pull out to release.
- J. **UPPER & LOWER GUARDS**—Provide operator protection.
- K. **TABLE TOP**—Hold material being cut solidly on table top.
- L. **FENCE**—Hold material being cut against fence.
- M. **ARBOR COLLARS** (not shown) — Place blade between collars with larger collar diameter against blade.
- N. **ARBOR NUT** — (not shown) — Secures blade — **TIGHTEN SECURELY.**
- O. **WING NUT** (Not shown) — Secures guard—**MAKE CERTAIN THAT THE GUARD IS PROPERLY POSITIONED OVER BOTH STUDS THEN TIGHTEN WING NUT SECURELY.**

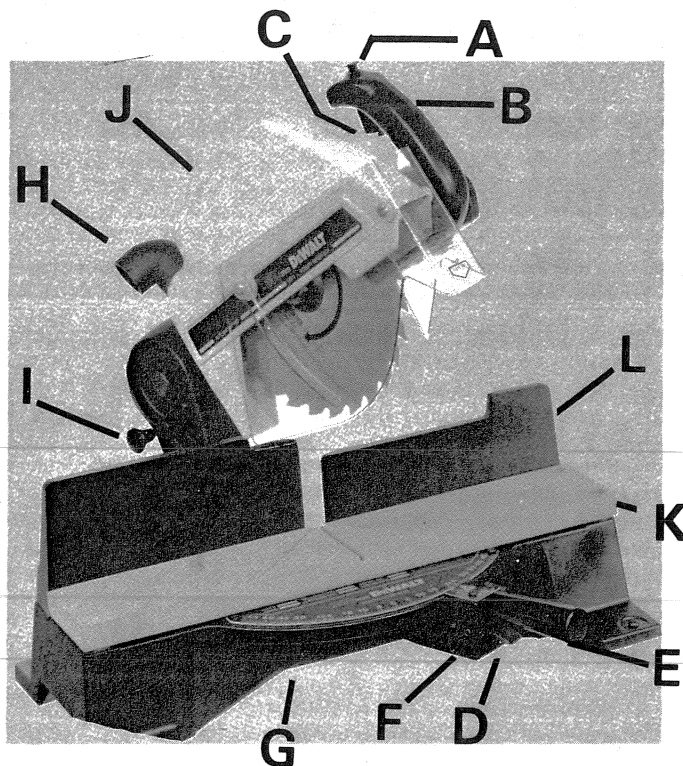

INTERNAL WIRING DIAGRAM

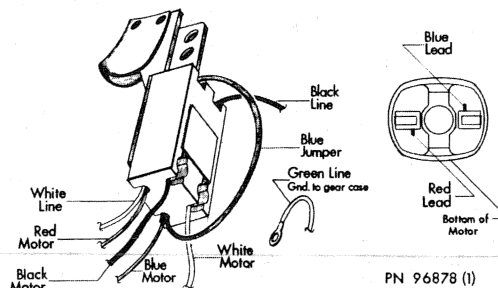

PN 96878 (1)

OPERATING INSTRUCTIONS

Observe and comply with the warning label affixed to the saw.

DANGER

KEEP HANDS AWAY
FROM BLADE



WARNING

FOR YOUR OWN SAFETY
READ INSTRUCTION MANUAL
BEFORE OPERATING SAW.

1. WEAR EYE PROTECTION.
2. DO NOT PERFORM ANY OPERATION FREEHAND.
3. MAKE NO ADJUSTMENTS UNTIL BLADE HAS STOPPED.

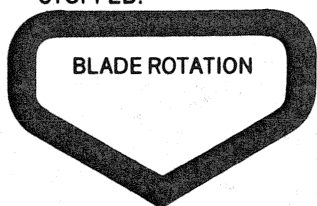

Use common sense, think all operations through before starting, and be alert.

CARRYING LOCK — The Power Miter Box is equipped with a carrying lock which locks the blade in a downward position. It is located on the left side of the rear pivot area.

To Release — push down lightly on the operating handle and pull the Carrying Lock Knob to the left. This will allow the blade to raise about 35°.

To Engage — lower the blade into a full-depth kerf and lock the miter knob in this position. While holding the operating handle down, push the Carrying Lock Knob firmly to the right.

CUTTING—The cutting operation is made in five steps described below. Extreme caution is required around this and other power tools to prevent possible injury.

STEP 1: SELECT MITER ANGLE—Release the carrying lock (if required) allowing the saw blade to rise out of the kerf in the table board. Do not start the motor. Unscrew the miter clamp knob about ¼ turn and hold the miter latch upward. Rotate the pivot arm until the wide center mark on the pointer indicates the desired angle. Note that the miter scale is calibrated in half-degree increments. Quarter-degree settings can be made by placing the wide center mark on the approximate location then moving the pivot arm slightly to keep the center mark between graduations and aligning one of the side ¼° marks with a scale graduation. Release the miter latch and tighten the Miter Clamp Knob finger tight. The miter latch will automatically locate miter angles of 0°, 22½° left and right and 45° left and right. To select one of these angles, release the miter latch and allow the latch to seat itself in the miter notch then tighten the miter clamp knob finger tight. If an angle within one degree of a miter notch is selected then the miter latch must be held up until the miter clamp knob is tightened.

STEP 2: PLACE WORKPIECE on the table top and against the fence, with the saw blade in the up position and the motor off and locating it so that the saw kerf will be in the correct position. Hold the workpiece firmly in position with your hand well away from the blade and guard area. **DO NOT ATTEMPT TO CUT SMALL PIECES AS YOUR HAND WILL BE DANGEROUSLY CLOSE TO THE BLADE. SUPPORT LONG WORK WITH AN OUTBOARD WORK REST.**

Never perform any operation “free hand” (i.e. supporting the workpiece by hand alone). The workpiece must always be solidly supported by the fence or supporting jig or fixture to prevent any unexpected movement.

STEP 3: START MOTOR. Firmly grasp the operating handle. Press the switch button then the trigger switch. The switch button may be released after the trigger switch is fully depressed. Allow a few seconds for the blade to reach maximum speed prior to cutting.

STEP 4: CUT WORKPIECE. While holding the workpiece firmly as described in Step 2, slowly and evenly lower the blade through the workpiece, raise the blade from the workpiece and release the trigger switch while holding onto the operating handle. Allow the automatic brake to completely stop the blade prior to moving either hand.

STEP 5: REMOVE WORK. When the blade has stopped, remove the workpiece and scrap. Use a short length of scrap to remove sawdust and scrap from the area adjacent to the blade rather than putting your hands in the blade area.

CUTTING TIPS

The smoothness of the resulting cut depends on the material, blade design, blade sharpness and rate of cut. To make a rough cut, as on framing lumber, a fairly rapid cut coupled with a sharp, aggressive blade will produce the most economical cutting. However, for smooth, accurate cutting, as on finished trim, a slow even cutting rate, along with a sharp blade designed to make smooth cuts will produce excellent cut quality. The blade shipped with the Power Miter Box is a general purpose blade. If it is not completely satisfactory, we suggest that you select a blade from the accessory blades according to your requirements and material being cut.

CHANGING BLADES

Blades are easily changed by following these step-by-step instructions:

STEP 1: DISCONNECT POWER: Remove the line cord plug from the receptacle. Place the plug in a location where someone will not plug it in by mistake.

STEP 2: REMOVE GUARD. Leave the saw motor in the up position. Remove the wing nut located on the top of the motor adjacent to the operating handle. Grasp the upper guard and raise it straight up and off the motor.

STEP 3: REMOVE BLADE. Place the large Allen wrench in the end of the arbor shaft. Place the open-end wrench on the brass arbor nut nearly parallel to the first wrench. Push downward on the open-end wrench and pull upward on the Allen wrench (left-hand threads). Remove the arbor nut, outer arbor collar and blade. It is not necessary to remove the inner arbor collar.

STEP 4: INSTALL BLADE. Clean the mating faces of the arbor collars and the blade to remove all dirt. Slide the blade onto the arbor shaft making certain that the blade marking indicates rotation in a clockwise direction when viewed from the end of the arbor shaft. Replace the outboard arbor collar (larger diameter against blade) and the arbor nut. Tighten the arbor nut *securely*.

STEP 5: REINSTALL GUARD. Lower the guard assembly (allowing the lower guard to hang freely) over the blade. Install the guard over the threaded stud and the solid pin. **CAUTION: MAKE CERTAIN THAT THE GUARD IS SEATED OVER BOTH THE PIN AND THE STUD.** Replace the wing nut and tighten *securely*.

CUTTING SUGGESTIONS

Here are several suggestions which will make the operation of your Power Miter Box easier and more accurate:

1. CROWN MOLDING

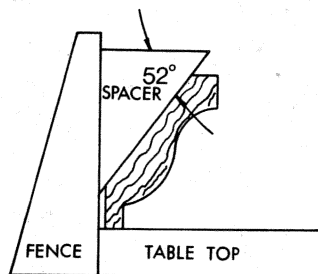

To make repeated cuts on crown molding, construct two spacer blocks 10" long as shown and fasten them with sheet metal screws through holes drilled through the fence. Make certain that the spacer blocks are located at the same distance from the table top.

2. COVE MOLDING

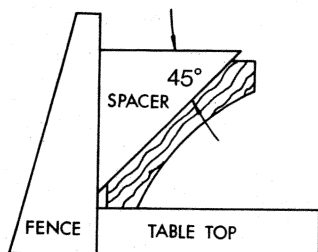

To make repeated cuts on cove molding, construct two spacer blocks 10" long as shown and fasten them with sheet metal screws through holes drilled through the fence. Make certain that the spacer blocks are located at the same distance from the table top.

3. FLAT MITERING DRESSED 4" MATERIAL

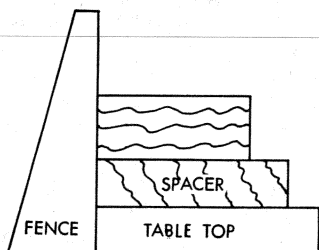

To flat miter 4" dimensioned material ($3\frac{1}{2}$ " or $3\frac{5}{8}$ " actual width), it is necessary to space the material above the table top. To do this, use 2 pieces of $\frac{5}{4}$ or 2" dimensioned lumber (1" to $1\frac{5}{8}$ ") as shown in the diagram. Fasten the spacers to the fence or table top.

ADJUSTMENT AND ALIGNMENT

Your DeWalt Power Miter Box was assembled, aligned and inspected at the factory prior to shipment, however, rough handling can affect the alignment. Adjustments are provided at all wear points to maintain the accuracy through the life of the tool. It is suggested that the Power Miter Box be adjusted whenever it fails to perform to the expected accuracy. Since one adjustment can affect another adjustment, perform all adjustments in the order shown. It is necessary to do some cutting to verify the alignment. Read and understand the cutting instructions and operating rules prior to cutting. **CAUTION: DISCONNECT THE ELECTRICAL POWER PRIOR TO MAKING ANY ADJUSTMENTS.**

UPPER PIVOT ADJUSTMENT: The upper pivot bolt has two functions: first, it loads the upper pivot to prevent excess motion; and second, it applies friction to control the counterbalance spring located in the pivot assembly. This adjustment must be made with the Power Miter Box fully assembled including the blade normally used. Loosen or tighten the pivot bolt by turning the hex head located on the left side of the pivot assembly until nearly all play is removed and the motor moves up slowly when released.

LOWER PIVOT ADJUSTMENT: Tighten the lower pivot bolt (under the base) until the lower pivot arm is moderately difficult to rotate. A trapped self-locking nut is provided so only one wrench is required.

TABLE TOP SQUARE TO BLADE: The table top must be square to the blade in order to make accurate miter cuts. Follow the steps below to check and adjust squareness.

1. Place a straight piece of wood (measuring about 1" x $3\frac{1}{2}$ " x 12") with the $3\frac{1}{2}$ " face against the left side of the fence and the 1" face against the table top. Cut the right side of the test piece. Place the wood inside a square of known accuracy keeping the edge that was against the table top against one leg of the square and the edge just cut against the other leg. If a gap shows between one portion of the cut end and the square then adjustment is required.
2. To adjust, loosen the locking nut and center support screw located under the miter scale. If the gap between the wood and the square is at the corner of the square, tighten the two screws on the left holding the table top to the base and loosen the two on the right in equal amounts (about $\frac{1}{4}$ turn). If the gap is away from the corner, tighten the two right screws and loosen the left screws in equal amounts. Place a straight edge (such as the long leg of a carpenter's square) on the table top parallel to the fence and over the center support screw. Raise or lower the center support screw until the table is level and lock the nut.
3. Repeat steps 1 and 2 until the cut edge is square. Check the table mounting screws for tightness as each must be tight enough as to not move under handling and use. If they are not tight enough, tighten each equally and readjust the center support screw.

TABLE TOP SQUARE TO FENCE. The top must be square to the fence in order to accurately locate the workpiece. Place an accurate square against the fence and the table top and over a pair of table top screws. Repeat for the other side. If each is not square adjust as follows:

1. Tighten the screw nearest the high spot to eliminate one-half of the error and loosen the screw nearest the low spot an equal amount. Repeat for the other side. Note that the table mounting screws must all be sufficiently tight to prevent movement during handling and use. If any are too loose, tighten each screw equally. Readjust the center support screw and tighten lock nut.

BLADE SQUARE TO FENCE. (0° miter). In order to make accurate miters, the blade must be square to the fence. Place a straight piece of wood (about 1" x 3½" x 12") flat on the left side of the table top with the 1" edge against the fence. Seat the Miter Latch in the 0° position and tighten the Miter Clamp Knob. Trim the right end of the test piece.

Place the cut piece in an accurate square with the side that was against the fence against one leg of the square and the cut surface against the other leg of the square. There should be no gap between the square and the wood. If a gap is noticeable then the blade must be adjusted square to the fence as follows:

1. Loosen, but do not remove, the (2) locking setscrews (located in front of the miter adjusting screws) and the Miter Clamp Knob. If the gap between the wood and the square is near the square's corner, loosen the right miter adjusting screw and tighten the opposite one. If the gap is away from the corner, loosen the left miter adjusting screw and tighten the opposite one. Lock the Miter Clamp Knob.
2. Repeat Step 1 until the cut edge is evenly against the square. Tighten one of the two locking setscrews. Run the unlocked adjusting screw against the miter latch snugly enough to eliminate all play, but loose enough to allow the spring to move the miter latch. Tighten the locking set screw for this adjusting screw.

ZEROING THE MITER POINTER. Engage the miter latch in the 0° position. Loosen the two screws holding the pointer to the pivot arm, move the pointer to 0° and retighten the screws. Do not allow the pointer to drag on the miter scale.

BRAKE FAILURE. If the saw blade does not stop within a few seconds after the trigger switch is released, check the brushes and commutator for wear. If these parts are within the wear limits below, assemble the motor and run the motor continuously (without cutting) for 5 minutes.

PREVENTATIVE MAINTENANCE

Your DeWalt Power Miter Box is engineered for extended usage with minimum maintenance. However, certain items should be checked periodically for the longest machine life. Failure to replace worn brushes can result in severe motor damage.

1. Check the brushes: Approximately every 5,000 operations, remove and measure the brush length.
2. Check the commutator for wear: When the brushes are removed inspect the commutator for wear. If the brushes have worn into the commutator more than 1/32" (1 MM), the commutator must be remachined or the armature assembly replaced.

3. Pay continuing attention to cut quality and any unusual noises. This will give advance warning for the need to sharpen the blade, align the saw, or tighten a loose part.

CLEANING NOTE: Do not use solvents or gasoline. Use a mild detergent.

BRUSH INSPECTION AND REPLACEMENT

1. Disconnect electrical power by removing the plug from the electrical receptacle. Place the plug in a safe location where it will not be accidentally plugged in.
2. Following the parts list diagram, remove the two screws from the motor end cap. Remove the end cap.
3. Blow the dust from the commutator area.
4. Note the orientation of the brushes and brush holders so that they can be replaced in the same manner and location. Pull the brush holders straight out about 1 inch and slide the brush holders off the brushes. Mark or locate the brush holders so that they can be replaced in the same location.
5. Measure the brush length remaining. Replace both brushes if either measures ¼" (6 MM) or less.
6. Polish the surface of the commutator by placing 220 grit or finer garnet sandpaper lightly against the full width of the commutator surface and rotate the arbor shaft slowly by hand.
7. Reassemble the unit following the disassembly procedure in reverse. Orient the brushes and brush holders the same as you found them, using the parts list diagram as a guide.
8. Run the saw motor continuously (without cutting) for 15 minutes when new brushes have been installed or 5 minutes if the old brushes were replaced. Failure to do this will cause erratic braking action.

PROHIBITED ACCESSORIES

The use of any cutting tool except saw blades which meet the requirements under recommended accessories is prohibited. Do not use accessories such as shaper cutters or dado sets.

RECOMMENDED ACCESSORIES

Accessories listed below are recommended for use with your Power Miter Box. Use only 10" or 250 mm diameter saw blades with a 5/8" arbor hole and marked for operation at 6000 or higher rpm. **THE USE OF ANY OTHER ACCESSORIES MIGHT BE HAZARDOUS.** The following blades and other items are suggested.

Cat. No.	Description	Suggested Usage
30101	Combination (Carbide)	Medium Fine Cuts
30010	Combination (Original Eqpt.)	General purpose, Slightly rough cuts
R1041	Combination (Premium)	Similar to 30010
R1013	Planer (Hollow Ground)	Excellent cuts for trim work
R989	Combination (Carbide)	Rough cutting with long life
35021	Deluxe Machine Stand - Stable work surface, 23" x 18-3/4" x 30-1/2" high. Rubber foot grommets.	
R9362	Deluxe Utility Cabinet - Holds Miter Box and has convenient storage space. Includes door and closed back.	
R9363	Casters - For use with either Utility Cabinet.	
35016	Deluxe Goggles - Elastic band and air vents. Meets OSHA requirements.	

G = Grease where shown using
type EP Molybdenum Disulphate
filled grease

L = Clean mating surface with Loctite
Primer T and secure with
Loctite Grade 35

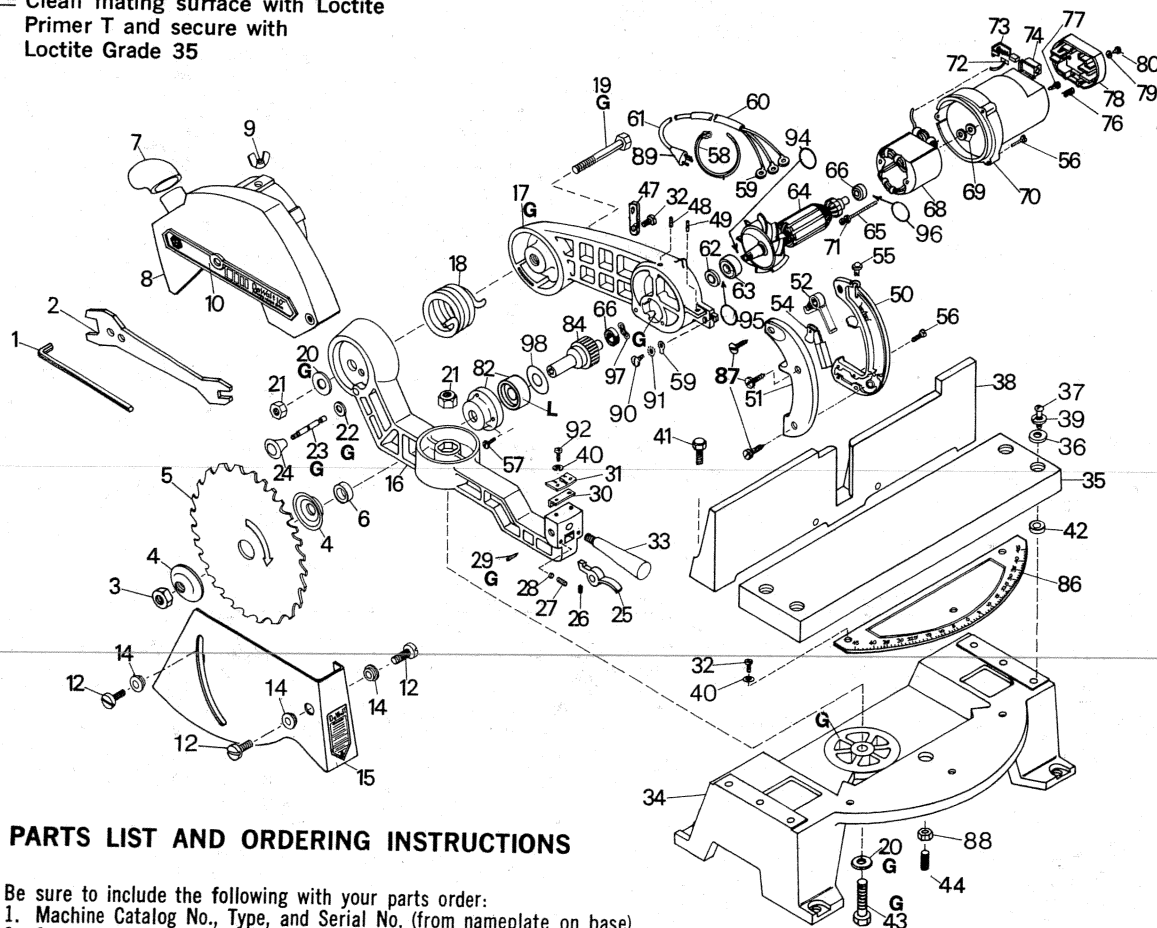

PARTS LIST AND ORDERING INSTRUCTIONS

Be sure to include the following with your parts order:

1. Machine Catalog No., Type, and Serial No. (from nameplate on base).
2. Quantity, Part No., and description of parts.
3. Complete shipping and billing instructions.

Index No.	Part No.	Description	Qty.	Index No.	Part No.	Description	Qty.	Index No.	Part No.	Description	Qty.
1	80138	5/16 Allen Wrench	1	35	121228	Table Board	1	66	52029	Ball Bearing	2
2	80137-01	Arbor Wrench	1	36	99360-05	1/4 Flat Washer	4	68	96856-71	Field (Incls. 72) (120 V)	1
3	80109	Arbor Nut	1	37	121219	1/4-20 x 1/2 Pan Hd. Screw	4	69	52070	Spacer Washer	3
4	80465-01	Arbor Collar	2	38	121215-02	Fence	1	70	94564	Field Case	1
5	30010	Blade (10" Combination)	1	39	34030	1/4 Lockwasher	4	71	82507	#10 Lock Washer	2
6	121757	Spacer	1	40	99464-03	#8 Lockwasher	5	72	72070	Terminal	2
7	80466	Dust Spout	1	41	121223	3/8-16 x 1 Hex Hd. Screw	2	73	121274-01	Brush (120 V)	2
8	121218-01	Upper Guard (Incl. No. 10)	1	42	121243	Rubber Washer	4	74	72012	Brush Holder	2
9	80101	5/16-18 Wing Nut	1	43	121717	Short Pivot Bolt	1	76	87205	Rubber Plug	2
10		Identification Label	1	44	80654	1/4-20 Set Screw	1	77	72016	Field Case Insert	2
12	52511	1/4-20 x 5/8 Pan Hd. Screw	3	47	121290	Cable Clamp (Flat)	1	78	72041	End Cap	1
14	121323	Shouldered Bushing	3	48	121253	Guard Stud	1	79	72511	Fiber Washer	2
15	121216-03	Lower Guard	1	49	96876	Groove Pin	1	80	99276-08	#8-32 x 1/2" Pan Hd. Screw	2
16	121226-01	Pivot Arm	1	50	121735	Switch Handle	1	82	121762-01	Cover & Bearing	1
17	121763	Upper Arm (Incl. Nos. 48, 49.)	1	51	121736	Handle Cover	1	84	121762-02	Arbor Shaft & Gear	1
18	121224	Torsion Spring	1	52	121734	Switch Cam	1	86	121918	Miter Scale & Nameplate	1
19	121717-01	Long Pivot Bolt	1	54	55094-01	Switch	1	87	87184	#8-16 Thd. Form Screw	1
20	121242	Curved Spring	2		99289-04	#6-32 x 1/4 Pan Hd. M Screw	6	88	99374-05	1/4-20 Nut	3
21	58197	Jam Nut	2	55	96869	Switch Button	1	89	234900-01	Attachment Plug	1
22	34158	"O" Ring	1	56	96912	#10-24 x 1" Fill Hd. Screw	7	90	80488	6-32 x 1/4 Pan Hd. S-T Screw	1
23	121227	Stop Pin	1	57	96911	#10-24 x 5/8" Fill Hd. Screw	3	91	36521	#6 Ext. Tooth Lockwasher	1
24	69532	Knob	1	58	71025	Cable Strap	2	92	80487	8-32 x 1/4 Pan Hd. Screw	2
25	121719	Miter Latch	1	59	33315	Terminal	9	94	701297	"O" Ring, 1-9/16 diam.	1
26	121244	Miter Latch Spring	1	60	121275	Sleeve	2	95	59989	"O" Ring, 1-3/8 diam.	1
27	82387	1/4-20 x 1/4 Set Screw	2	61	81373-01	Cord & Plug (Incl. Nos. 59 & 89)	1	96	37388	"O" Ring, 7/8 diam.	1
28	103522	Setcrew Slug	2	62	73155	Slinger	1	97	88093	Wavy Washer	1
29	121613	5/16-24 Cup Point Screw	2	63	92341	Ball Bearing	1	98	36278	Slinger	1
30	121221	Wear Spring	1	64	96920-31	Armature & Fan (120 V)	1				
31	121919	Pointer	1	65	99298-40	#10-32 x 2-1/2" Pan Hd. Screw	2				
32	80489	8-32 x 3/8 Pan Hd. Screw	5								
33	121230	Handle	1								
34	121207-03	Base	1								

PARTS NOT SHOWN

83104	1/8 Allen Wrench	1
99056-06	5/32 Allen Wrench	1
96878	Wiring Diagram	1

FACTORY SALES and SERVICE CENTERS

	Area Code	Telephone No.		Area Code	Telephone No.
ALABAMA: Birmingham 35209, 2412 Green Springs Highway	205	942-0538	MINNESOTA: Bloomington (Minneapolis-St. Paul) 55420	612	884-9191
Mobile 36608, 3831 Airport Boulevard	205	343-6624	712 Garfield Ave.	612	884-9191
ARIZONA: Phoenix 85013, 4501 North 7th Avenue	602	278-6414	MISSOURI: Kansas City 64111, 4324 Main St.	816	531-0629
ARKANSAS: Little Rock, 72201, 519 West Seventh Street	501	372-3040	Kansas City 64111, 4324 Main St. (Sales only)	816	531-0633
CALIFORNIA: Anaheim 92801, 1235 South Euclid Avenue	714	772-4050	St. Ann 63074, 10933 St. Charles Rock Road	314	739-4661
Fresno 93710, 5412 North Blackstone Avenue	209	435-0810	St. Louis 63044, 4534 N. Lindbergh (Sales only)	314	731-7968
Long Beach 90805, 2011 South Street	213	422-5825	St. Louis 63131, 12852 Manchester Road	314	821-8740
Los Angeles 90007, 2432 S. Broadway	213	478-0371	NEBRASKA: Omaha 68127, 4225 South 84th Street	402	592-5666
Orange 92668, 822 Town and Country Road (Sales only)	714	547-7667	NEW JERSEY: Cherry Hill 08034, 1444 E. Marlton Pike	609	429-2822
Riverside 92505, 4010 Merrill Avenue	714	787-9700	Pateron (Little Falls) 07424, Rt. 46 East, at Lower Notch Rd.	201	296-8373
Sacramento 95825, 2033 Fulton Avenue	916	872-9090	Union 07883, 2305 U.S. Highway 22 West	201	964-7040
San Diego 92105, 3811 El Cajon Blvd.	619	280-3331	(1 Block West of Flagship)		
San Francisco Bay (Sales only)			NEW MEXICO: Albuquerque 87107, 2812 Candelaria Road N.E.	505	884-1002
Burlingame 94010, 1801 Bayshore Highway, Suite 101	415	692-2910	NEW YORK: Albany (Latham) 12110, 836 Troy-Schenectady Rd.	518	785-1867
San Jose 95128, 1185 South Bascom Avenue	408	293-7390	Buffalo 14209, 381 W. Delaware Ave.	716	884-8220
San Leandro 94578, 15206 E. 14th St.	415	276-1610	New York 10010, 50 West 23rd Street (Manhattan)	212	929-6450
S. San Francisco 94080, 1139 Airport Blvd. (Service only)	415	671-7278	New York 11590, 1061 Old Country Rd. (Westbury L.I.)	516	997-6140
Van Nuys 91411, 14920 Victory Blvd.	213	787-5531	New York 11377, 56-15 Queens Blvd. (Woodside)	212	335-1042
West Covina 91791, 422 North Azusa Avenue	213	339-6286	New York 10710, 2347 Central Park Avenue (Yonkers)	914	779-3810
COLORADO: Denver 80219, 1171 South Federal Boulevard	303	822-8320	Port Washington 11050, 14 Vandewater Ave. (Sales only)	516	944-7200
CONNECTICUT: Orange 06477, 481 Boston Post Road	203	795-3583	Rochester 14623, 2969 West Henrietta Road	716	424-1310
Hartford (Wethersfield) 06109, 682 Silas Deane Highway	203	563-5800	Syracuse (DeWitt) 13214, 3485 Erie Blvd. E.	315	446-3098
DISTRICT OF COLUMBIA: Washington			NORTH CAROLINA: Charlotte 28205, 3007 E. Independence Blvd.	704	374-1779
Bladensburg, Maryland 20710, 4501 Baltimore Avenue	301	779-3808	Greensboro 27407, 3716 High Point Road	919	852-1300
Falls Church, Virginia 22046, 344 West Broad Street	703	533-7313	Raleigh 27604, 2420 Atlantic Avenue	919	834-8207
FLORIDA: Jacksonville 32205, 920 Cassat Avenue	904	781-2253	OHIO: Cincinnati 45241, 2310 E. Sharon Road	513	772-3111
FL. Lauderdale 33334, 799 E. Oakland Park Boulevard	305	566-0102	Cleveland 44113, 3901 Detroit Avenue	216	651-4243
Miami 33168, 13345 N. W. Seventh Avenue	305	861-6668	Columbus 43227, 3975 E. Livingston Avenue	614	237-0461
Orlando 32803, 3807 East Colonial Drive (Service only)	305	894-7011	Dayton 45409, 2998 South Dixie Drive	513	296-1951
Winter Park (Orlando) 32789, 611 Wymore Road (Sales only)	305	628-0836	Toldeo 43607, 3231 Dorr Street	419	531-8921
St. Petersburg (Pinellas Park) 33965, 7211 U.S. Highway 19, North	813	525-0273	OKLAHOMA: Oklahoma City 73106, 1318 Linwood Blvd.	405	232-7515
Tampa 33609, 5432 W. Kennedy Blvd.	813	672-5317	Pittsburgh 15232, 5437 Baum Blvd. E.	412	622-5666
GEORGIA: Stone Mountain (Atlanta) 30086			OREGON: Portland 97209, 1640 N.W. Johnson Street	503	228-8631
5723 Memorial Dr. (Service only)	404	292-4714	PENNSYLVANIA: Allentown (Whitehall) 18052		
Stone Mountain (Atlanta) 30086, 5723 Memorial Drive (Sales only)	404	294-8220	2242 MacArthur Road	215	435-8544
HAWAII: Honolulu 96813, 875 Auaui Street	808	536-9374	Harrisburg 17112, 6070 Allentown Blvd.	717	545-0851
ILLINOIS: Chicago 60610 (Addison), 1710 W. Armitage Court	312	261-8630	Lancaster 17604, 715 Fountain Avenue	717	393-5251
Chicago 60648 (Lincolnwood), 8710 N. Crawford Avenue	312	673-0923	Philadelphia 19103, 333 North 20th Street	215	564-5520
Chicago 60453 (Oak Lawn), 6343 West 96th Street	312	423-7212	Pittsburgh 15232, 5437 Baum Blvd. E.	412	362-2700
Des Plaines 60018, 1277 South Elmhurst Road	312	384-5220	Wayne 19087, 125 Stratford Avenue		
Moline 61260, 4433 23rd Ave.	309	762-3000	Stratford Building #3 (Sales only)	215	688-0267
Schiller Park 60176, Suite 300, 9960 W. Lawrence Ave. (Sales only)	312	671-7880	RHODE ISLAND: E. Providence 02914, 2777 Pawtucket Avenue	401	434-1655
INDIANA: Evansville 47710, 307 First Avenue, Crescent Center	812	425-4289	SOUTH CAROLINA: Greenville 29601, 407 Pendleton Street	803	232-3038
Hammond 46329, 7103 Kennedy Avenue	219	945-5100	TENNESSEE: Chattanooga 37404, 1425 E. Main Street	615	629-7270
Indianapolis 46204 (W. 42nd St.), 5909 Crawford Avenue	317	243-8308	Knoxville 37917, 4110 North Broadway	615	688-0921
IOWA: Des Moines 50312, 2811 Ingersoll Avenue	515	244-7257	Memphis 38116, 1085 East Brooks Road	901	332-3444
KANSAS: Wichita 67213, 155 S. West Street	316	943-1271	Nashville 37211, 4811 Nolensville Road	615	833-8277
KENTUCKY: Louisville 40213, 4624 Preston Highway	502	366-1495	TEXAS: Amarillo 79106, 3008 West 8th Avenue	806	373-1531
LOUISIANA: Metairie (New Orleans) 70002			Austin 78757, 6549 Burnet Road	512	459-1133
3524 N. Causeway Blvd.	504	837-2550	Dallas 75207, 1808 N. Industrial Blvd. (Service only)	214	741-6401
Shreveport 71105, 4434 Youree Drive	318	636-0571	Dallas 75234, 14388 Proton Road (Sales only)	214	934-1425
MARYLAND: Baltimore 21211, 203 West 28th Street	301	467-7411	El Paso 79925, 1400 Magruder Street	915	778-9769
Baltimore 21205, 4715 Erdman Avenue	301	455-5550	Fort Worth 76103, 1801 Bomar Street	817	336-0175
Bladensburg (Wash. D.C.) 20710, 4501 Baltimore Avenue	301	779-3808	Houston 77022, 836 E. Tidwell Road	713	692-7111
Lutherville (Greenapring) 21093, 2360 W. Joppa Road (Sales only)	301	828-3001	San Antonio 78201, 500 Culebra Avenue	512	732-1221
Timonium (Baltimore) 21109, 1617 York Road	301	561-0500	UTAH: Salt Lake City 84115, 1541 S. Third West Street	801	468-5628
MASSACHUSETTS: Boston (Brighton) 02136			VIRGINIA: Falls Church 22046, 344 West Broad Street	703	533-7313
12 Market St. (Service only)	617	782-6284	Norfolk 23513, 7631 Sewalls Point Road	804	480-3333
Boston (Brighton) 02135, 46 Leo Birmingham Parkway (Sales only)	617	782-4665	Richmond 23222, 1424 Chamberlayne Avenue	804	649-9245
MICHIGAN: Detroit 48219, 18133 W. McNichols Rd.	313	534-8880	WASHINGTON: Seattle 98109, 701 Third Avenue, N.	206	282-6432
Grand Rapids 49508, 3040 28th Street, South East	616	949-8331	Seattle 98005, 1682 136th Pl. N.E. Bellevue (Sales only)	206	641-5170
Southfield 48076, 21411 Civic Center Drive (Sales only)	313	353-3480	Spokane 99208, North 7011 Division Street	509	489-9164
Warren 48093, 27035 Van Dyke Blvd.	313	756-8711	Tacoma 99409, 2602 South 38th Street	206	473-6040
			WEST VIRGINIA: Charleston 25312, 1638 Sixth Avenue	304	343-0289
			WISCONSIN: Milwaukee (West Allis) 53227, 10903 W. Lincoln Ave.	414	545-9590

AUTHORIZED SERVICE STATIONS

ALABAMA: Andalusia, Taylor Parts & Supply Co.	INDIANA: Elkhart, Dunlap Electric Tool Repair	NORTH DAKOTA: Bismark, Acme Elec. Motor Co.
Huntsville, Tool Service Co.	FL. Wynne, Power Tool Supply Inc.	Fargo, Acme Welding Supply Co.
Montgomery, Dwight's Lawn & Garden	IOWA: Cedar Rapids, Janda Electric	Grand Forks, Acme Electric Motor Company
Sheffield, Alabama Electric Motor Service	Davenport, Industrial Engineering Equipment Co.	OHIO: Akron, Automotive Supply & Equip. Co.
Tuscaloosa, Electric Motor & Supply Co.	KANSAS: Garden City, NAB Electric	Canton, Electric Service & Supply Co.
ALASKA: Anchorage, Aero Services Company	KENTUCKY: Bowling Green, Covington Electric Service	Cleveland, Equipment Warehouse Inc.
Fairbanks, Fairbanks Aero Services Company	Lexington, Lexington Industrial Service Co., Inc.	Youngstown, Moffatt Motor Power Tools, Inc.
ARIZONA: Tucson, Electric Motor Company	Owensboro, Owensboro Armature Works, Inc.	OREGON: Eugene, Jim's Electric Motor Service
ARKANSAS: Ft. Smith, H. Prock Tool & Equipment	Paducah, Warden Electric Co.	PENNSYLVANIA: Erie, Perry Mill Supply Co.
Jonesboro, Arkansas Industrial Electric Supply Co., Inc.	LOUISIANA: Baton Rouge, Baton Rouge Electric Motor Service	Dickson City, Dan's Repair Service
Russellville, Al-Ark Electric	MAINE: Bangor, N.H. Bragg & Sons	Lentwood, Versall Equipment Company
CALIFORNIA: Concord, Electric Euro Service	Westbrook, Shale Electric Works	Mechanicburg, Power Tools Service
Ecorseville, Imperial Tool Co.	MARYLAND: Delmar, Peninsula Elec. Motors	Reading, Reading Electric Motor Service, Inc.
Fairfield, S. & S. Sharpening Center	Easton, Easton Hardware + Furniture, Inc.	Roslyn, Tompkins Electric
Imperial, Imperial Tool Co.	Galtherburg, Walters Appliance Service	SOUTH CAROLINA: Charleston, Charleston Supply Company
Modesto, Stanislaus Electric	MASSACHUSETTS: Springfield, Utility Electric Service, Inc.	Charleston, Delta Industrial Electric Company, Inc.
Redding, Electric Tool & Motor Repair	MICHIGAN: Petoskey, Petoskey Electric Motor Service	Columbia, Mann Electric Repair Company
Stockton, Stockton Armature Works	MINNESOTA: Dodge Center	SOUTH DAKOTA: Aberdeen, J.B. Electric
COLORADO: Ft. Collins, Osborn Hardware Co.	Southern Minnesota Machinery Sales	Rapid City, Industrial Electric & Supply Co.
Grand Junction, Cross Electric Mtr. Service	Duluth, Gunderson Equipment & Supply	Everett, Stan Houston Equipment Company
CONNECTICUT: New Haven, New Haven Electric Machine Co.	Willmar, Northern States Supply	TENNESSEE: Jackson, Tool Service Center
FLORIDA: Cocoa, Neelco Industrial Tools	MISSISSIPPI: Greenville, V & G Welding Supply	TEXAS: Austin, Hamilton Electric Works
Grand Junction, Cross Electric Mtr. Service	Gulfport, Wizard Service Center	Austin, The Tool Box
Hialeah, Dade Equipment Service	Jackson, Flamenco Electric Co., Inc.	Brownsville, Imperial Electric Motor Service
Melbourne, Stephens Hardware, Inc.	MISSOURI: Springfield, Electric Motor Service & Supply	Corpus Christi, Smith Shields Electric Works
Panama City, Holiday Electronics, Inc.	Springfield, Middle Earth Air & Electric Company	Hartington, Lewis Electric Motors, Inc.
Pensacola, Electric Motor Service, Incorporated	NEW JERSEY: Billings, Ted's Electric Service	Lubbock, Anderson Young Electric
Tallahassee, Van Brunt & Yon, Inc.	Great Falls, Moon Electric Motors, Inc.	Odessa, Electric Service & Supply Company
GEORGIA: Augusta, Augusta Mill & Supply Co.	Kalspell, Electric Motor	Wichita Falls, Westbrooks, Inc.
Macom, C.H. Farmer Co.	Missoula, Electric Service Center	Wichita Falls, Wichita Sup. Div. MRO GR
Savannah, White Hardware	NEBRASKA: Hastings, Hatten's Electric Service	UTAH: Orem, Mending Shed
Valdosta, Whitehead Hardware Co.	Lincoln, Lincoln Tool Center	VERMONT: S. Burlington, Burlington Rent All
HAWAII: Hilo, Hawaii Planning Mill Ltd.	McCook, Knapp Electric	VIRGINIA: Hampton, The E.G. Wilkins Company, Ltd.
Kahului Maui, Maui Power Tool Service	Nebraska, Knapp Electric	Portsmouth, Taylor Rental Center
Kapa, Appliance & Electric Services, Inc.	NEVADA: Las Vegas, Tool Services, Inc.	Rosano, Lloyd Electric Company
IDAHO: Boise, Boise Tool Company	NEW JERSEY: Kew-Forest, Air & Electric Tool Svc.	WASHINGTON: Tacoma, Ajax Electric Company, Inc.
Boise, Mazon Electric Co.	Ocean View, Bill's Saw Service	Yakima, Cooper Elec. Motor Service
Lewiston, Wadsworth's Saw & Tool Service	Trenton, Lockwood's Electric Motor Service	WEST VIRGINIA: Martinsburg, Biedler Electric Motor Repair
ILLINOIS: Bloomington, The Struck Co.	NEW MEXICO: Farmington, Noel's Inc.	Wheeling, Warwood Armature Repair Co.
Bradley, Arthur Motor Works	NEW YORK: Bay Shore, Turnpike Appliance Service	WISCONSIN: Green Bay, Power Tool Service Company
Decatur, Miller Industrial Supply Co.	Howard Beach, Cross Bay Appliance Service	Madison, Richard E. Etc. Company
Effingham, Hoelscher Sales & Service	NORTH CAROLINA: Asheville, Hayes & Lunford Electric Co.	Shabogun, Willard Quasius Co.
Ill. R & A Electric Service, Inc.	Elizabethtown, Miles Jennings, Inc.	WYOMING: Casper, Casper Saw Shop
Matton, S&N Rigging Corporation		Rock Springs, Electric & Air Repair Service
E. Peoria, C & H Repair		
Quincy, Richards Electric Motor Co.		
Rockford, Machinist Tool Co.		
Springfield, James Machinery		



IMPORTANT!

To assure product RELIABILITY, repairs, maintenance and adjustment, should be performed by Black & Decker Service Centers or DeWALT Authorized Service Centers, always using DeWALT replacement parts.

IMPORTANT!

HOME & COMMERCIAL USE WARRANTY (A LIMITED WARRANTY)

Black and Decker warrants this product for one year from date of purchase. We will repair without charge, any defects due to faulty material or workmanship. Please return the complete unit, transportation prepaid, to any Black & Decker Service Center or Authorized DeWALT Service Station. This warranty does not apply to accessories. This warranty gives you specific legal rights and you may have other rights which vary from state to state. Should you have any questions, contact your nearest Black & Decker Service Center Manager.



Division of Black & Decker (U.S.) Inc.

715 Fountain Ave., Lancaster, Pa. 17601, (717) 393-5831, Telex: 84-8413

Form No. 724938-01

(OCT81-CD)

Printed in U.S.A.